

iTrack TEC Series

TL12-30W

Reflector

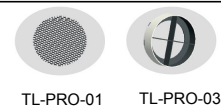

Technical Parameters:

Name	Parameters
Light source:	COB
Input Voltage:	AC220~240V 50/60Hz
LED Current:	700mA,35-07V
Rated life:	>50,000 hours
Operating temperature:	-20℃~40℃
Storage temperature:	-30℃~60℃
Certificate:	TUV/CE/RoHS
Weight:	1.75KG

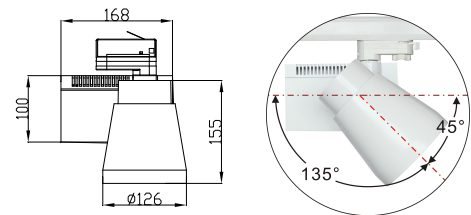

Ordering Information:

○White ●Black

Power	CRI	Beam Angle	Luminous	CCT	Housing	Part Number
30W	>80	▲ 12°	2830 lm	3000K	○	TL124-30W-830-W-12
					●	TL124-30W-830-B-12
		3030 lm	4000K	○	TL124-30W-840-W-12	
				●	TL124-30W-840-B-12	
		▲ 20°	2860 lm	3000K	○	TL124-30W-830-W-20
					●	TL124-30W-830-B-20
	3050 lm	4000K	○	TL124-30W-840-W-20		
			●	TL124-30W-840-B-20		
	▲ 45°	2740 lm	3000K	○	TL124-30W-830-W-45	
				●	TL124-30W-830-B-45	
	2920 lm	4000K	○	TL124-30W-840-W-45		
			●	TL124-30W-840-B-45		
>90	>90	▲ 12°	2590 lm	3000K	○	TL124-30W-930-W-12
					●	TL124-30W-930-B-12
		2690 lm	4000K	○	TL124-30W-940-W-12	
				●	TL124-30W-940-B-12	
		▲ 20°	2600 lm	3000K	○	TL124-30W-930-W-20
					●	TL124-30W-930-B-20
	2720 lm	4000K	○	TL124-30W-940-W-20		
			●	TL124-30W-940-B-20		
	▲ 45°	2480 lm	3000K	○	TL124-30W-930-W-45	
				●	TL124-30W-930-B-45	
	2600 lm	4000K	○	TL124-30W-940-W-45		
			●	TL124-30W-940-B-45		

Technical Data test pattern

CRI80 12°

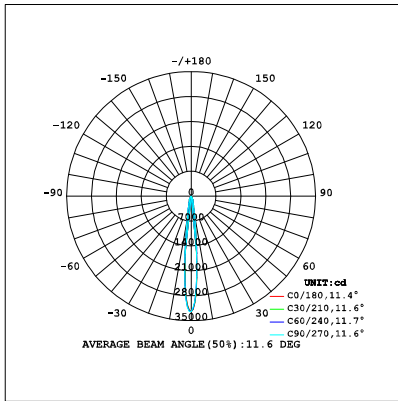

3000K

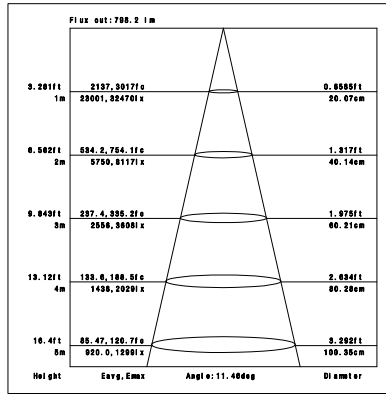

4000K

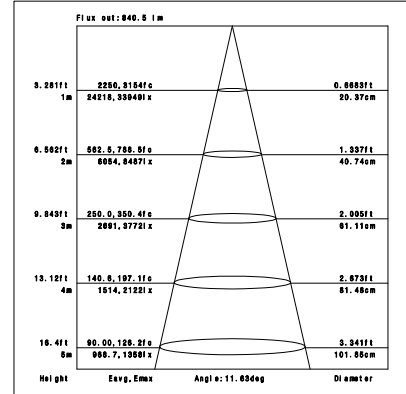

CRI80 20°

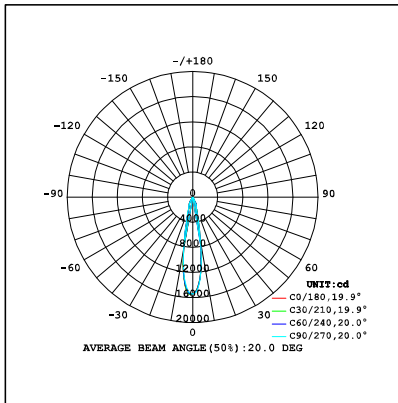

3000K

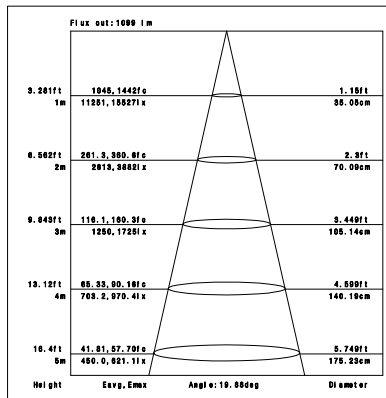

4000K

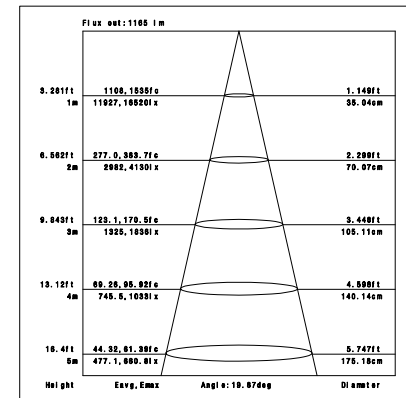

CRI80 45°

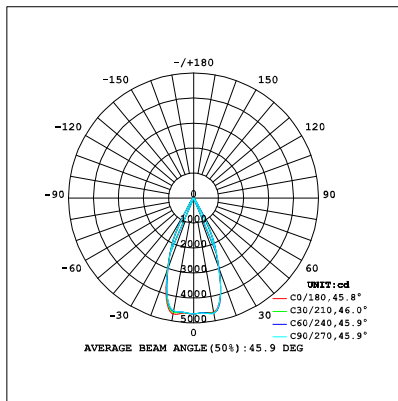

3000K

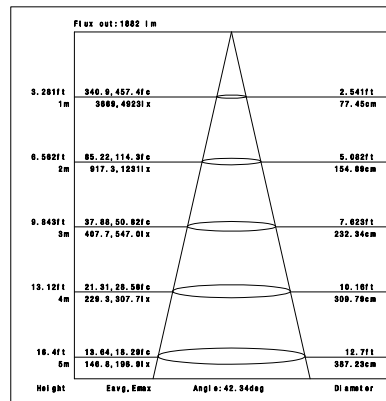

4000K

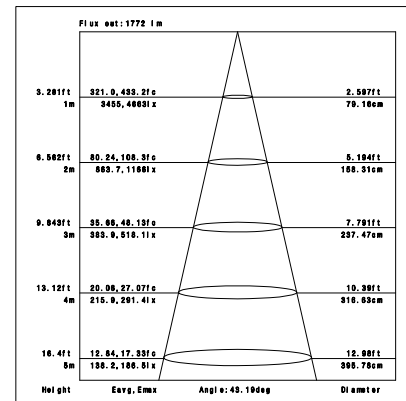

CRI90 12°

3000K

4000K

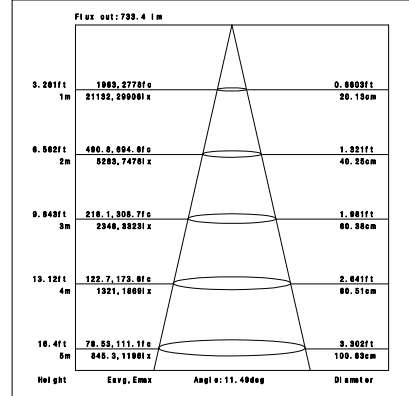
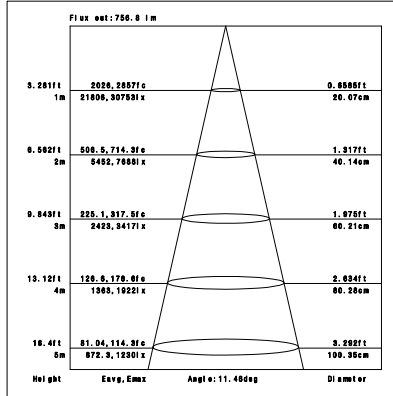
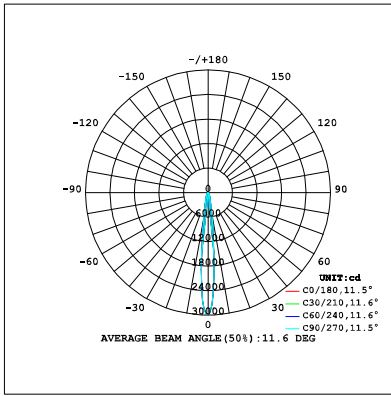

CRI90 20°

3000K

4000K

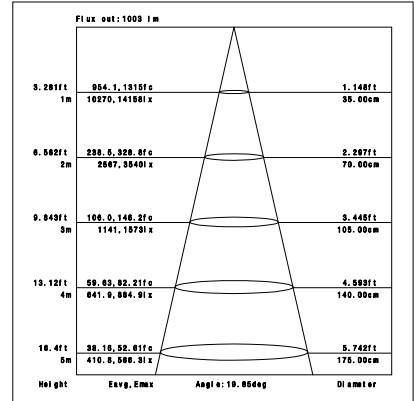
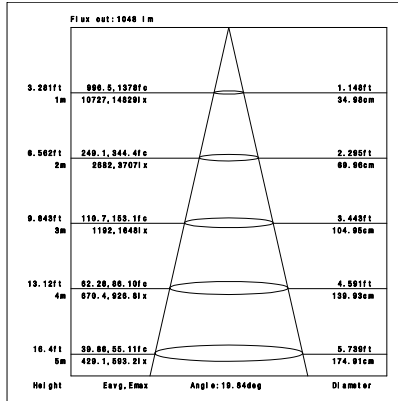
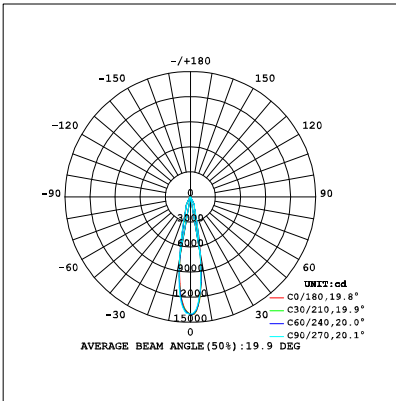

CRI90 45°

3000K

4000K

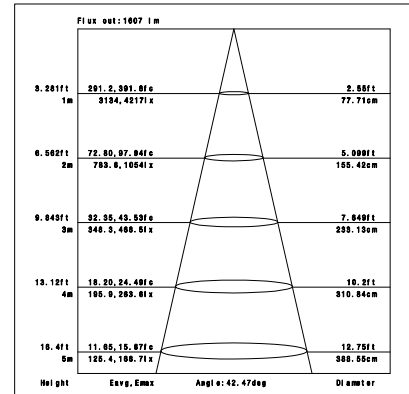
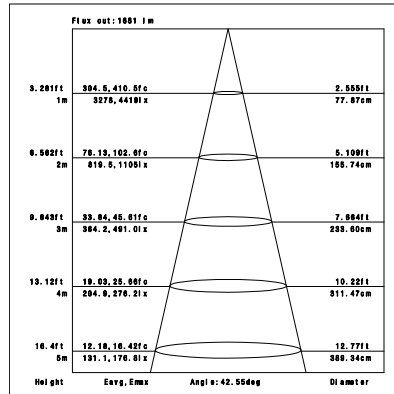
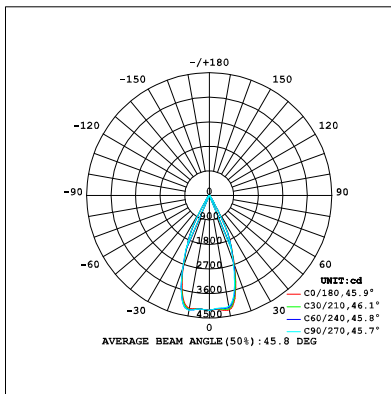

Installation instruction

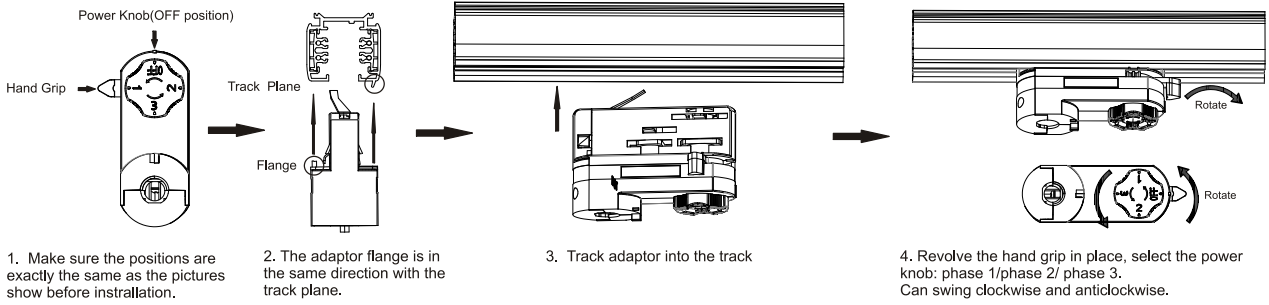

Remove Instructions

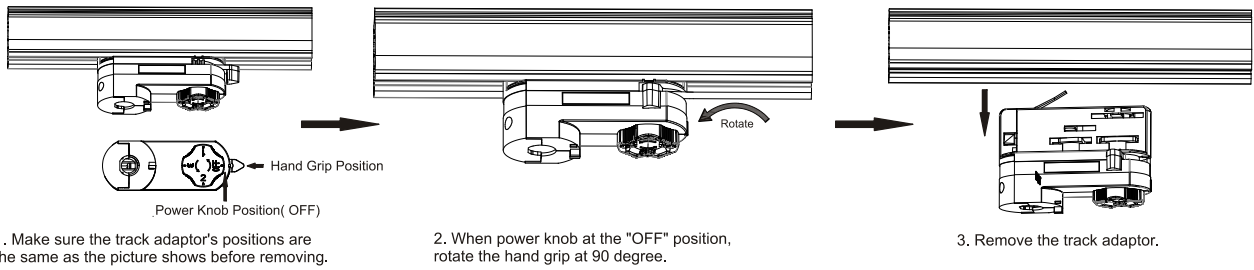

Cautions

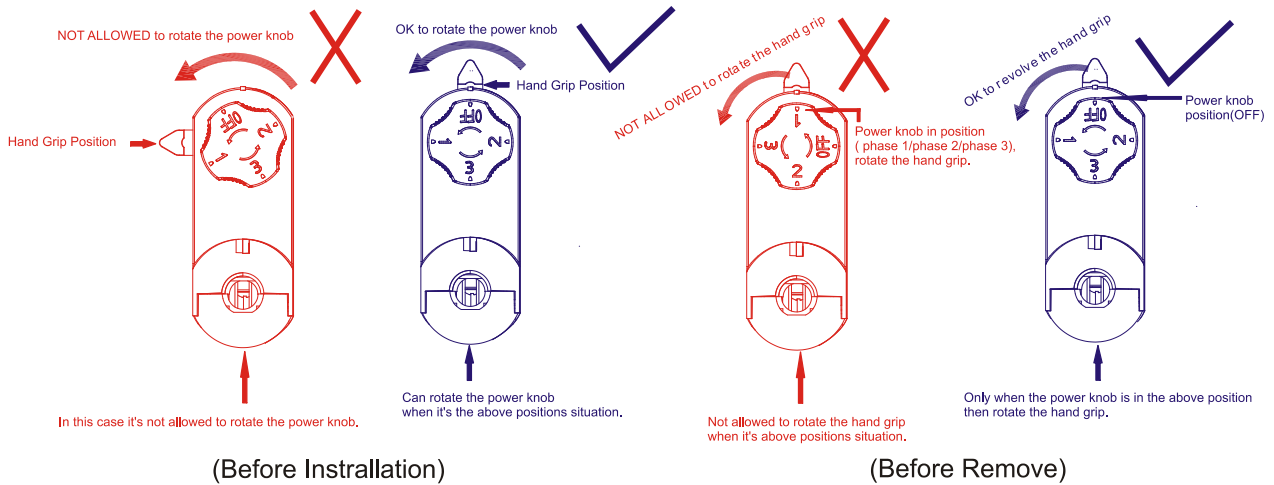

Packaging:

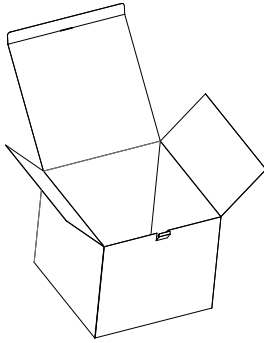

Box
 L245*W245*H220mm
 1pc/box
 GW: 1.95kg/box

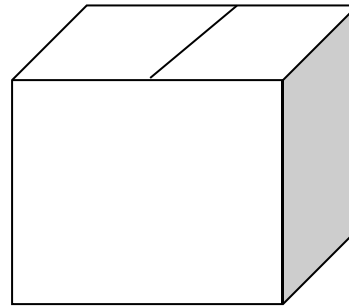

Outer carton
 L520xW520xH460mm
 8 pcs/CTN
 GW: 17kg/carton

Product naming system

