

iTrack PRO Series

TL10-40W

Reflector

Technical Parameters:

Name	Parameters
Light source:	COB
Input Voltage:	AC220~240V 50/60Hz
LED Current:	1000mA, 35-37V
Rated life:	>50,000 hours
Operating temperature:	-20°C~40°C
Storage temperature:	-30°C~60°C
Certificate:	TUV/CE/RoHS
Weight:	1.75KG

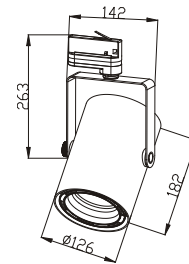

Ordering Information:

○ White ● Black

Power	CRI	Beam Angle	Luminous	CCT	Housing	Part Number
40W	>80	▲ 12°	4140 lm	3000K	○	TL104-40W-830-W-12
					●	TL104-40W-830-B-12
		4420 lm	4000K	○	TL104-40W-840-W-12	
				●	TL104-40W-840-B-12	
		▲ 20°	4180 lm	3000K	○	TL104-40W-830-W-20
					●	TL104-40W-830-B-20
	4350 lm	4000K	○	TL104-40W-840-W-20		
			●	TL104-40W-840-B-20		
	▲ 45°	4030 lm	3000K	○	TL104-40W-830-W-45	
						●
	4140 lm	4000K	○	TL104-40W-840-W-45		
			●	TL104-40W-840-B-45		
>90	▲ 12°	3530 lm	3000K	○	TL104-40W-930-W-12	
						●
	3700 lm	4000K	○	TL104-40W-940-W-12		
					●	TL104-40W-940-B-12
	▲ 20°	3550 lm	3000K	○	TL104-40W-930-W-20	
						●
3740 lm	4000K	○	TL104-40W-940-W-20			
				●	TL104-40W-940-B-20	
▲ 45°	3400 lm	3000K	3000K	○	TL104-40W-930-W-45	
						●
3650 lm	4000K	○	TL104-40W-940-W-45			
				●	TL104-40W-940-B-45	

Technical Data test pattern

CRI80 12°

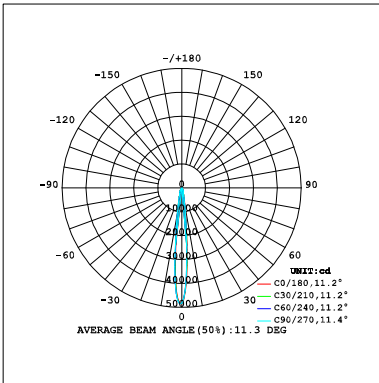

3000K

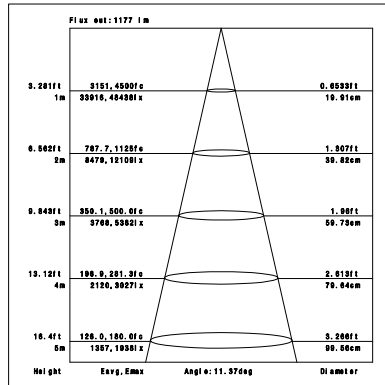

4000K

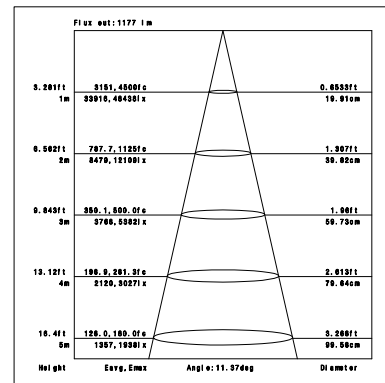

CRI80 20°

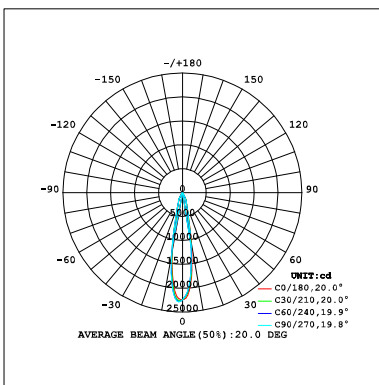

3000K

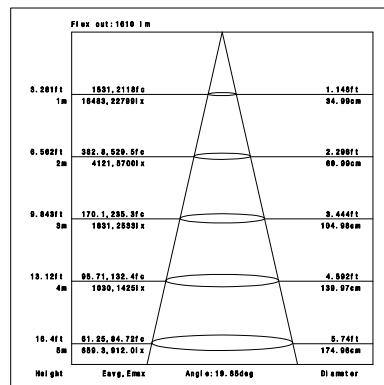

4000K

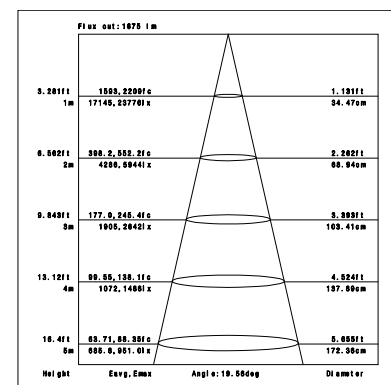

CRI80 45°

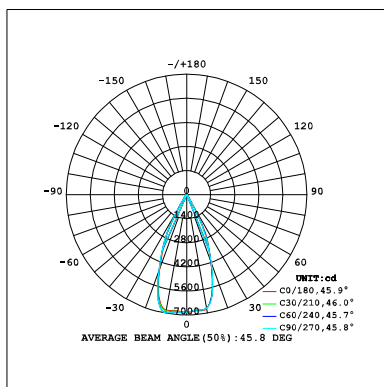

3000K

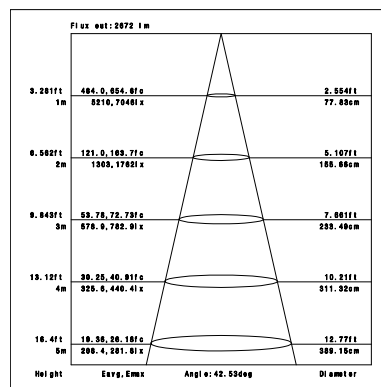

4000K

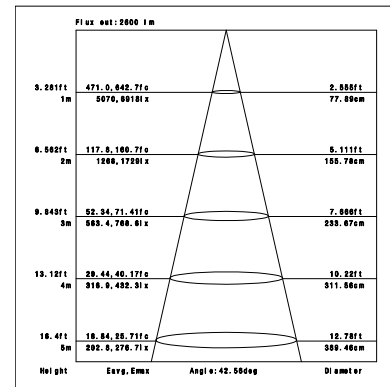

CRI90 12°

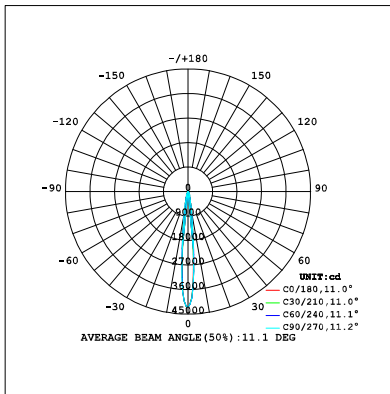

3000K

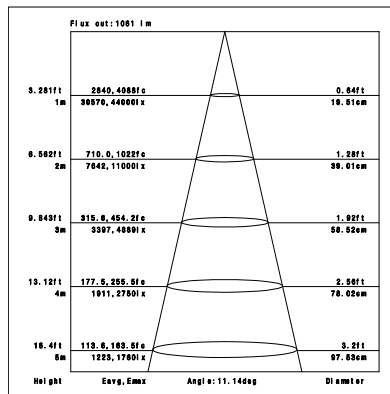

4000K

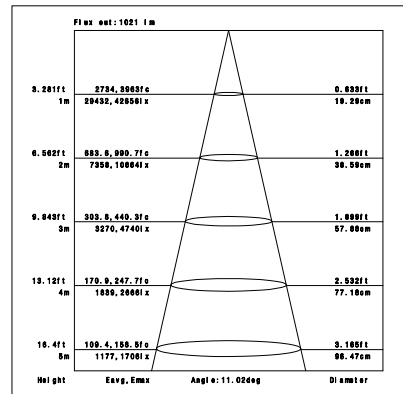

CRI90 20°

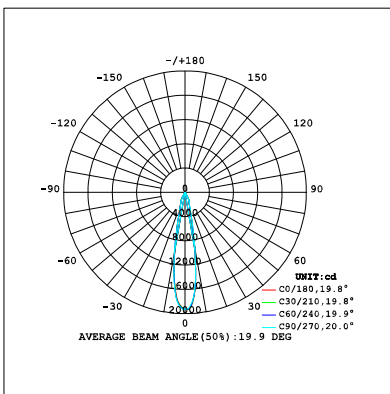

3000K

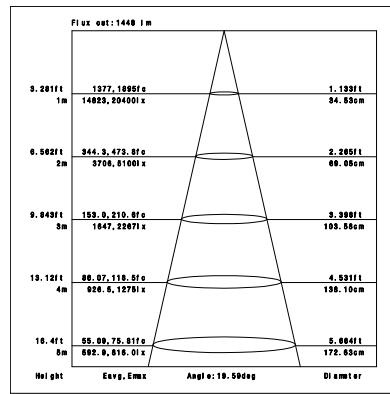

4000K

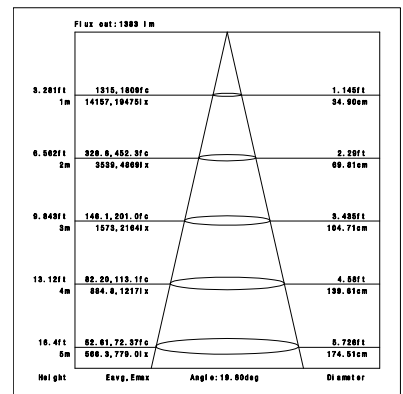

CRI90 45°

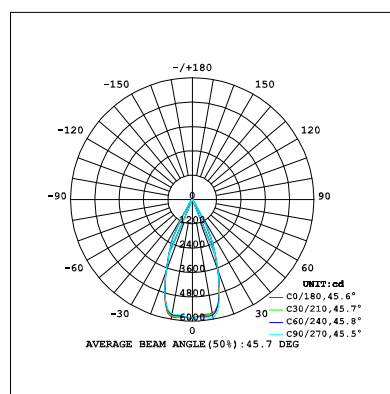

3000K

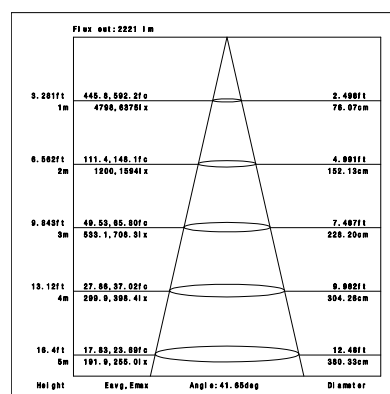

4000K

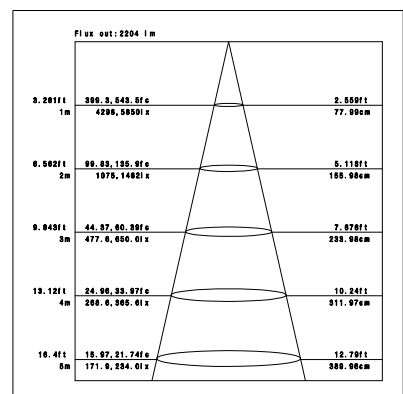

Installation instruction

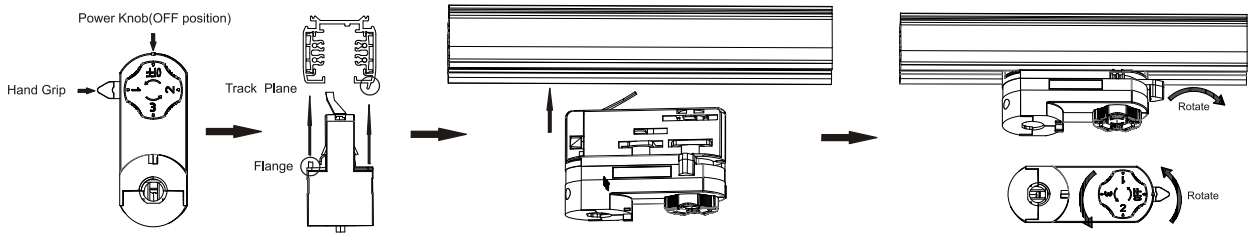

1. Make sure the positions are exactly the same as the pictures show before installation.
2. The adaptor flange is in the same direction with the track plane.
3. Track adaptor into the track
4. Revolve the hand grip in place, select the power knob: phase 1/phase 2/ phase 3. Can swing clockwise and anticlockwise.

Remove Instructions

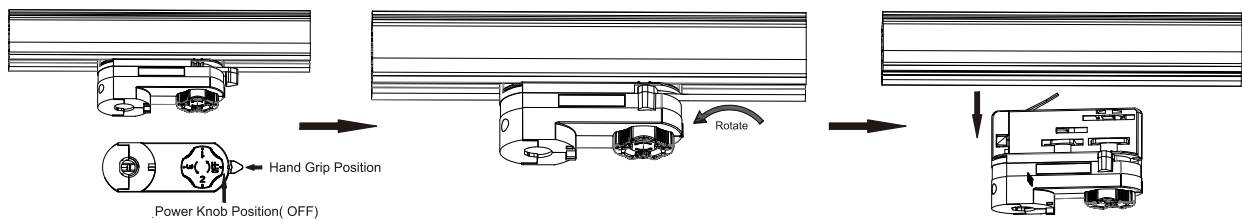

1. Make sure the track adaptor's positions are the same as the picture shows before removing.
2. When power knob at the "OFF" position, rotate the hand grip at 90 degree.
3. Remove the track adaptor.

Cautions

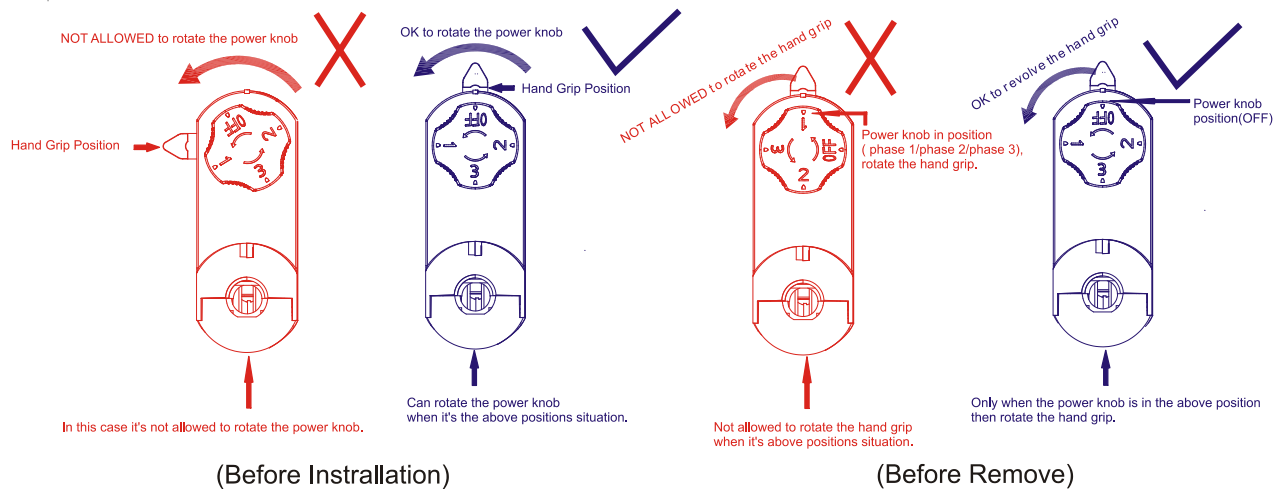

Packaging:

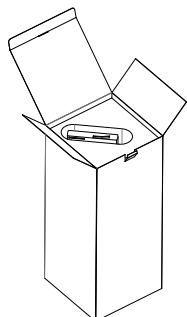

Box
 L140*W140*H340mm
 1pc/box
 GW: 2.0kg/box

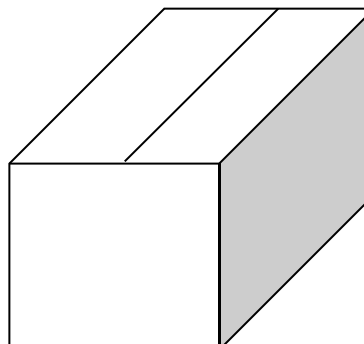

Outer carton
 L720xW310xH370mm
 10 pcs/CTN
 GW: 21.5kg/carton

Product naming system

TL (X) XX X (H) – XW – X XX – X- XX

